

**Installation and Commissioning**

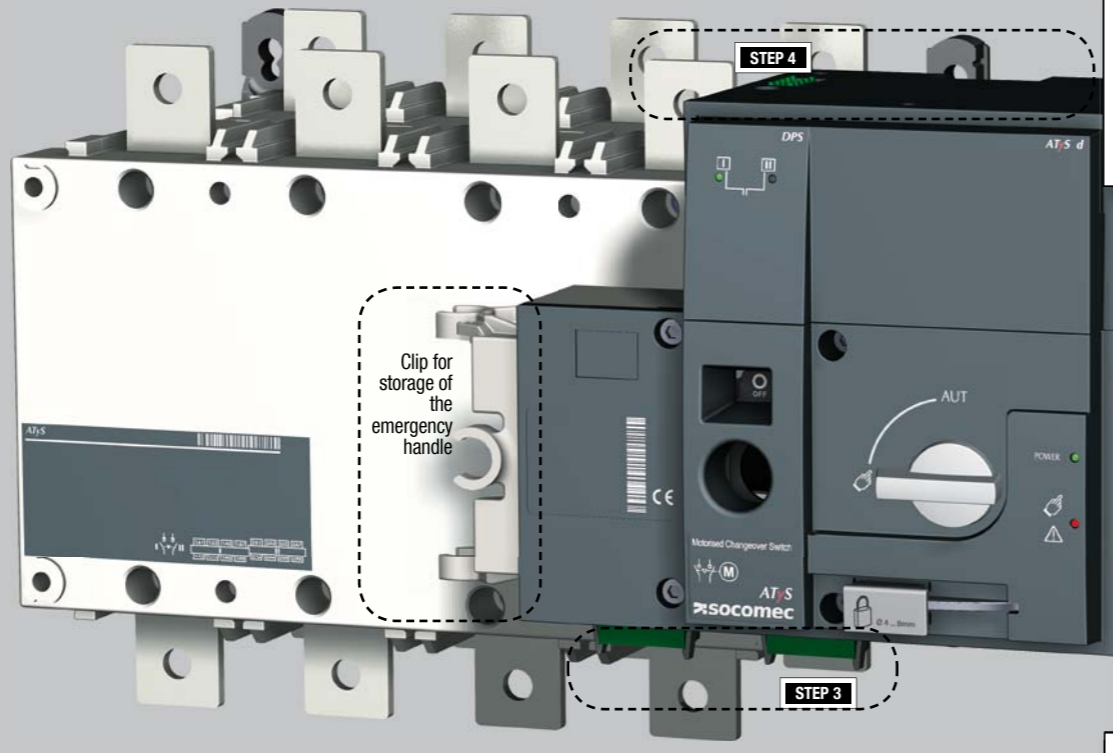

**STEP 1 Installation**

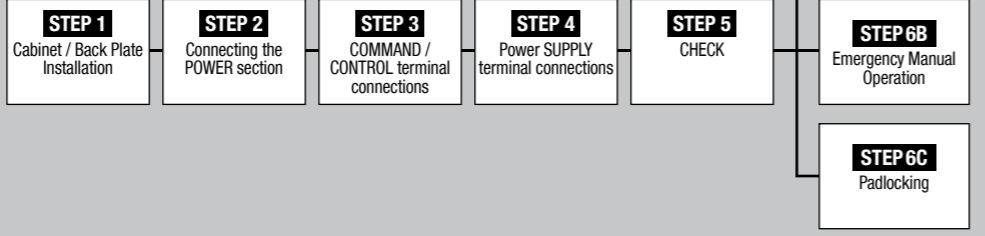
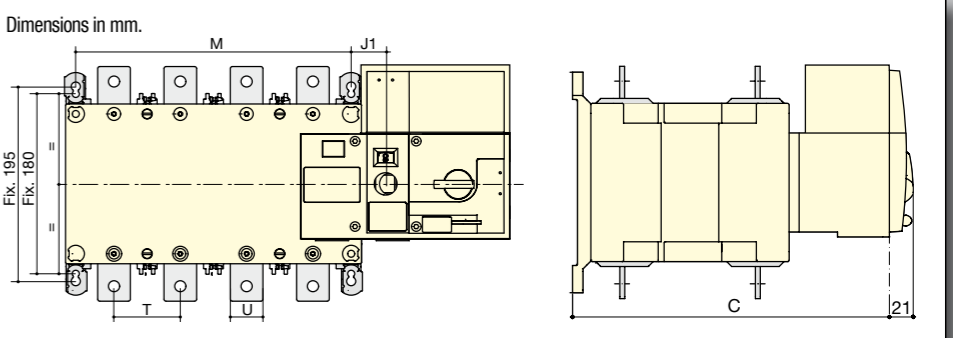
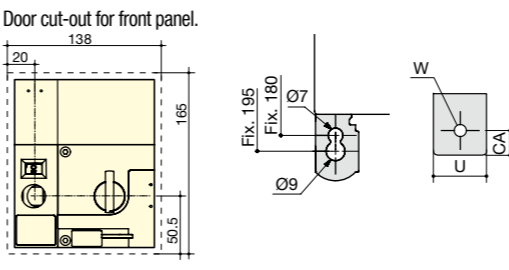
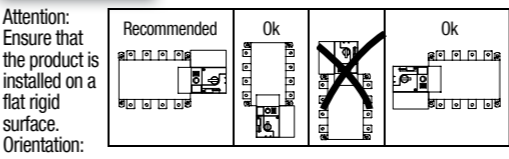

	125 A		160 A		200 A		250 A		315 A		400 A		500 A		630 A	
	3 P	4 P	3 P	4 P	3 P	4 P	3 P	4 P	3 P	4 P	3 P	4 P	3 P	4 P	3 P	4 P
<b>J1</b>	34	34	34	34	34	34	35	35	35	35	35	35	34	34	34	34
<b>M</b>	120	150	120	150	120	150	160	210	160	210	160	210	210	270	210	270
<b>T</b>	36	36	36	36	36	36	50	50	50	50	50	50	65	65	65	65
<b>C</b>	244	244	244	244	244	244	244	244	244	244	244	244	320	320	320	320
<b>U</b>	20	20	20	20	20	20	25	25	35	35	35	35	32	32	45	45
<b>W</b>	9	9	9	9	9	9	11	11	11	11	11	11	13	13	13	13
<b>CA</b>	10	10	10	10	10	10	15	15	15	15	15	15	20	20	20	20

**Preliminary operations**

- Check the following upon delivery and after removal of the packaging:
- Packaging and contents are in good condition.
  - The product reference corresponds to the order.
  - Contents should include:
    - Qty 1 x ATyS d
    - Qty 1 x Emergency handle and fixing clip
    - Quick Start instruction sheet

**Warning**

- ⚠ Risk of electrocution, burns or injury to persons and / or damage to equipment.**
- This Quick Start is intended for personnel trained in the installation and commissioning of this product. For further details refer to the product instruction manual available on the SOCOMEC website.
- This product must always be installed and commissioned by qualified and approved personnel.
  - Maintenance and servicing operations should be performed by trained and authorised personnel.
  - Do not handle any control or power cables connected to the product when voltage may be, or may become present on the product, directly through the mains or indirectly through external circuits.
  - Always use an appropriate voltage detection device to confirm the absence of voltage.
  - Ensure that no metal objects are allowed to fall in the cabinet (risk of electrical arcing).
- Failure to observe good engineering practises as well as to follow these safety instructions may expose the user and others to serious injury or death.
- ⚠ Risk of damaging the device**
- In case the product is dropped or damaged in any way it is recommended to replace the complete product.

**Accessories**

- Bridging bars and connection kits.
- Control voltage transformer (400Vac -> 230Vac).
- DC power supply (12/24Vdc -> 230Vac).
- Mounting spacers to raise the product x 10mm.
- Phase barriers.
- Terminal shrouds.
- Terminal screens.
- Auxiliary contacts (Additional).
- Padlocking in 3 positions (I - 0 - II).
- Lockout accessories (RONIS - EL 11 AP).
- Door escutcheon frame.
- Control relay ATyS C30 + D10 or D20.
- Control relay ATyS C40.
- ATyS D10 Interface (remote display).

For further details refer to the product instruction manual under chapter "Spares and Accessories"

[www.socomec.com](http://www.socomec.com)

To download, brochures, catalogues and technical manuals:  
<http://www.socomec.com/en/documentation-atys-d>

CORPORATE HQ CONTACT:  
SOCOMECSAS, 1-4 RUE DE WESTHOUSE, 67235 BENFELD, FRANCE

Printing informations: 1 color Black. White paper 90g/m<sup>2</sup>.  
Printing size: 420x297. Final size 210x297. This page visible first.

541 988 E - 10/16 - EN

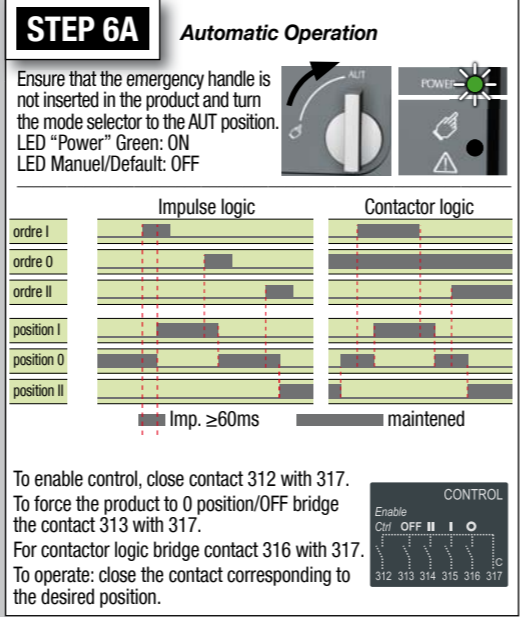
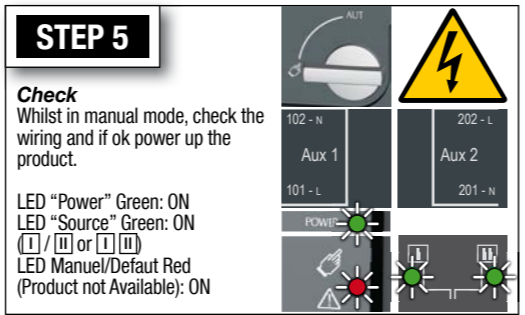

**STEP 3 CONTROL / COMMAND Terminals - Ensure that the product is in Manual Mode.**

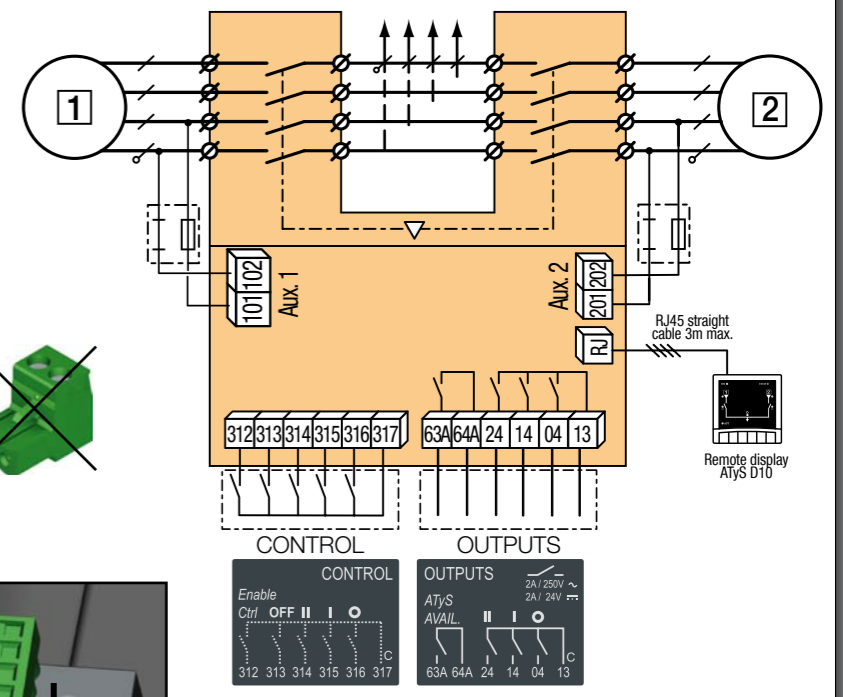
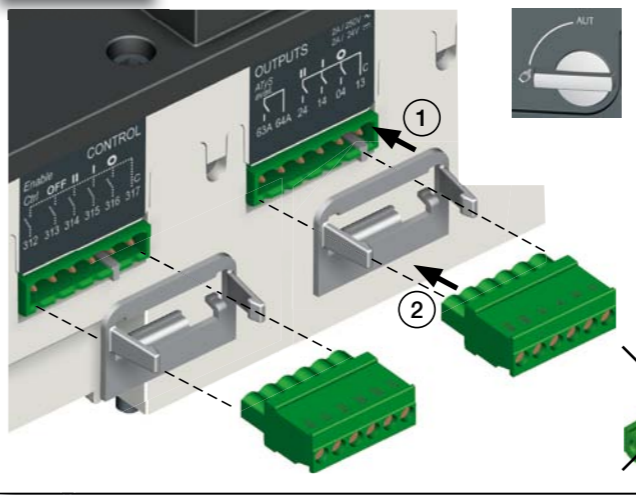

**STEP 4 Dual Power Supply Terminals**



Connect the product with a cable of section of 1,5 to 2,5 mm<sup>2</sup>.  
Screw M3 - Tightening torque: min.: 0.5 Nm - max.: 0.6 Nm